



Waterfall Table and Basin Playground Pump

Owner's Manual

Serial No. _____



Table of Contents

Waterfall Table System Components	4
Supply & Drain Line Components.....	4
Required Tools	5
Step 1 - Unboxing.....	5
Step 2 - Anchoring	9
Step 3 - Attaching the Pump.....	13
Step 4 - Attaching the Tank	14
Step 5 - Attaching the Tank Lines	15
Step 6 - Filling the Tank	16
Step 7 - Operation of the Pump.....	16
Maintenance.....	16
Winterizing the System.....	17

Appendix

Detail A: Waterfall Table System Components	19
Detail B: Waterfall Table System Piping.....	20
Detail C: Waterfall Table System Dimensions	21
Detail D: Waterfall Table Pump & Tank.....	22

Detail E: Concrete Installation Layout	23
Detail F: Exploded Parts Diagram... ..	24
Detail G: Part Listing	25

Contact

Please read and understand all instructions. If help is needed or you have questions regarding your product, you can email technical support at sales@CadronCreekPlay.com or call our toll-free number **1-888-403-7867**.

Waterfall Table System Components:

- 1) One (1) Lil Guppy Playground Pump (A)
- 2) One (1) Waterfall Table (B)
- 3) One (1) Basin Table (C)
- 4) One (1) Tank Assembly (D)
- 5) One (1) Access panel (E)
- 6) Four (4) Pump Fasteners (F) (Bolts with Security Nuts)
- 7) Eighteen (18) Anchor Plate Fasteners (G) (Mounting Bolts with Washers & Security Nuts)
- 8) One (1) Security Nut Socket (H)
- 9) One (1) Security Bolt Bit (J)
- 10) Two (1) $\frac{3}{4}$ " GHT Male Connection Ball Valves (K-1 & K-2) (Tank Inlet & Drain)
- 11) One (1) $\frac{3}{4}$ " GHT Male Connection (L) (Basin Drain)
- 12) Ten (10) Anchor Plate Brackets (M) (See Detail E for details)
- 13) Eight (8) $\frac{3}{8}$ " Concrete Wedge Anchors (N) with Washers & Nuts

Supply & Drain Line Components (Details B & D):

Note: Review all diagrams and the water supply line components before starting the installation process.

Add the following items to the incoming water supply line:

- 1) Shut off valve (R)
- 2) Pressure reducing valve (P) (if you know the line pressure exceeds 60 PSI)
- 3) Backflow preventer valve (Q) if required by your local or state regulations
- 4) The supply line (S) to the tank should not be smaller than $\frac{3}{4}$ " diameter from the supply valves to the line connection on the underside of the tank. From that point use a flexible line (X) such as a braided fountain supply line to connect to the inlet ball valve (K-1) that is attached to the bottom left of the tank.

Add the following items to the drain line(s):

- 1) Use a flexible line (X) to connect to the drain ball valve (K-2) on the bottom right of the tank.
- 2) Use a flexible line (X) to connect to the basin drain connection (L) on the bottom of the basin. Note: Both drain lines should follow local drainage codes.

Required Tools:

One (1) pair of wire cutters, one (1) box cutter, one (1) 7/32" allen wrench, one (1) 5/16" allen wrench, one (1) security nut socket (H) (provided), one (1) torque wrench if available, one (1) hammer drill or rotary hammer with corresponding 3/8" bit, and one (1) steel hammer

Note: Use safety glasses and gloves during installation and assembly.

Step 1 - Unboxing of the Waterfall Table System:

Note: The Waterfall Table System will ship in one (1) 78" x 48" x 36" (LxWxH) crate weighing approximately 500 lbs. **See Photo 1.**

Note: Please verify that you have received everything that you ordered. If there is anything that is missing or does not match, please call Cadron Creek Play immediately to correct the situation.

- 1) Loosen and remove the ratchet straps to remove the lid. Set lid aside for return.



Photo 1 – Shipping Crate

- 2) Fold down the side pockets to gain better access inside the crate if needed. (See Photo 2)
Pull up and out to fold side pockets down.
- 3) Remove the banding and open the Playground Pump, Tank Assembly, and anchor hardware each packaged inside its labeled box. (See Photo 2)



Photo 2 – Crate Side Pocket and packaging



Photo 3 – Waterfall Table Banding



Photo 4 – Waterfall Table Banding

- 4) Remove the two (2) bands around the Waterfall Table Assembly (See Photos 3 & 4)
- 5) The Waterfall Table Assembly should now be free to be removed from the crate
Note: Discard any cardboard or other packing material.

- 6) Once outside the crate, remove the access panel (Detail F – Item 4) of the Waterfall Table Assembly by removing the four (4) 3/8"-16 x 1.5" Socket Head Bolts and washers using a 5/16" allen wrench or hex bit. (See Detail F Items 17 & 18)

Note: Set aside panel and fasteners.
(See Step 6 for when to reattach)

- 7) Remove the banding around the Basin Table Assembly (See Photo 5).
- 8) The Basin Table Assembly should now be free to be removed from the crate.
- 9) To return the crate, fold each side down by starting with the short end walls.
- 10) Press the white tabs inward and fold each short end down to the middle of the crate (See Photos 6, 7, 8, 9).



Photo 5 – Basin Table Banding



Photo 6 – Side Folding Tabs



Photo 7 – Side Folding Tabs



Photo 8 – First Collapsible Side



Photo 9 – Second Collapsible Side

11) Fold each of the longer side walls down toward the middle of the crate (See Photos 10 & 11)



Photo 10 – Third Collapsible Side



Photo 11 – Fourth Collapsible Side

- 12) Place the lid on top making sure each corner is covered and tighten the three (3) ratchet straps as shown until snug. There are holes near the bottom of the crate base to attach strap hooks to. (See Photo 12)

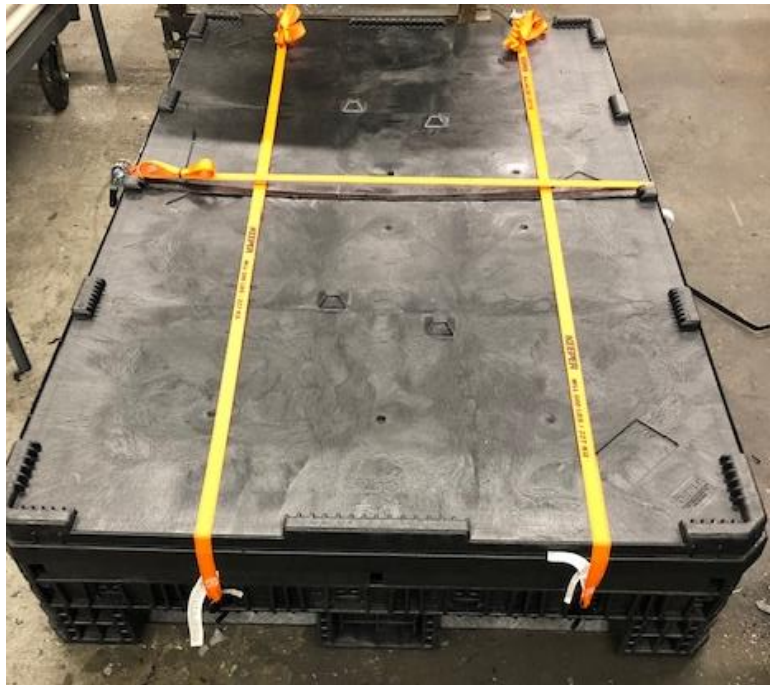

Photo 12 – Return Shipment

Step 2 - Anchoring of the Waterfall Table and Basin Table:

Before deciding on the location of your Waterfall Table System, you should consider the physical limitations of the entire system. The system should be installed in a location that meets the vertical and horizontal pumping limitations of the Lil Guppy Playground Pump.

(See Detail C)

Note: For anchoring of the Waterfall Table System, the minimum recommended concrete slab dimensions are shown in Detail E. Concrete should be as level as possible and completely set before starting the installation process. Concrete depth should be at least 4". Please follow all other practiced guidelines for concrete construction.

Note: The Basin Table must be anchored before the Waterfall Table.

- 1) Place the complete Waterfall Table System on the concrete in position of where it will be installed.
Note: It is recommended that anchor holes be at least 6" away from the edge of the concrete.
- 2) Make an outline of the bottom of all anchor plates except the two short anchor plates (M-3, M-4).

Note: Be as accurate as possible when outlining anchor plates.

- 3) After outlining each anchor plate, remove the Waterfall Table System from its location being careful not to remove the outline on the concrete. Remove each anchor plate from the waterfall table system except for the two short anchor plates. Use a 7/32" allen wrench and the provided security nut socket.

Place each anchor plate back on its outline. Be sure that it matches all corners of the outline (check **Detail E** for anchor plate locations). Now mark the concrete for the location of the anchor holes (the bottom hole on each anchor plate). (There are 8 total anchor holes)

Note: Be as accurate as possible when marking and drilling anchor holes.

- 4) Drill a 3/8" hole at least 3" deep at each of the marked hole locations on the concrete. (There are 8 total holes)

Note: Be as accurate as possible when marking and drilling anchor holes.

Note: A hammer drill or rotary hammer should be used with its corresponding 3/8" drill bit. Be sure to clean inside and around each hole for dust and debris after drilling.

- 5) Once the holes are drilled and cleaned out, position the anchor plates (M) in their corresponding positions **(See Detail E)**.
- 6) With a 3/8" flat washer & 3/8"-16 hex nut on the wedge anchor (N) before hammering, leave no more than ~1/2" of threads exposed at the top of the wedge anchor **(See Photo 13)**.



Photo 13 – Wedge Anchor Reference

- 7) With each anchor plate (M) in place, use a steel hammer to drive the wedge anchor through the drilled hole while going through the hole in the bottom of the anchor plate bracket (M). **(See Photo 14)**



Photo 14 – Anchor Plate & Anchor Install

- 8) Hammer the wedge anchor (N) until the flat washer is flush with the anchor plate (M). Make sure anchor plates are square with each other and level (use shims if needed). Then tighten the hex nut to the recommended torque value of 20 ft.-lbs. **(DO NOT OVERTIGHTEN)**
- 9) Once all anchor plates (M) are secured, place the Basin Table Assembly (C) in place and attach each anchor plate using the provided fasteners (G) and tools.
 Note: The logo on the Basin Table Assembly (C) should match the logo on the Waterfall Table Assembly (B). **(See Photo 17)**
 Note: Use the 3/8"-16 x 1.75" Long Button Head Cap Bolts with washers and security nuts. **(See Photos 15 & 16)**



Photo 15 – Basin Table Anchor Bolts



Photo 16 – Basin Table Anchor Nuts



Photo 17 –Basin Table Logo Orientation

Note: The exposed anchor will fit through the bottom of each basin table leg.

Note: Attach each anchor plate fastener hand tight at first, then fasten using tools while alternating sides until all fasteners are fully tightened. Recommended torque value is 20 ft-lbs.

- 10) Once the Basin Table Assembly (C) is fully secured, place the Waterfall Table Assembly (B) in place and attach each anchor plate (M) using the provided fasteners (G) and tools in the same method as the Basin Table Assembly.

Note: Use the 3/8"-16 x 2.25" Long Button Head Cap Bolts with washers and security nuts. (See Photos 18 & 19)



Photo 18 – Waterfall Table Anchor Bolts



Photo 19 – Waterfall Table Anchor Nuts

Note: The access panel (E) will need to stay removed to fasten the two upstream anchor plates (M-1 & M-2) (See Photo 19). Leave the access panel set aside.

Step 3 - Attaching the Lil Guppy Playground Pump (A):

- 1) Place the Lil Guppy Playground Pump (A) on top of the pump platform (V) so that the fittings fit through the access hole. (See Photo 20)
Note: The spout should be facing downstream towards the Basin Table Assembly (C). Reference Detail A.
- 2) Use the provided fasteners (F) to secure the pump to the pump platform (V).
Note: Insert the bolts through the top and attach the washers and security nuts on the bottom side of the pump platform (V).
Note: Use the 3/8"-16 x 2.25" Long Button Head Cap Bolts with washers and security nuts. (See Detail F – Items 12, 15, 16)



Photo 20 – Pump Placement Reference

Step 4 - Attaching the Waterfall Table Tank (D):

- 1) Remove the access panel (E) and lower the tank support bolts (I) (if not already done).
- 2) Set tank (D) inside the back opening, push up on the quick connect socket (Item 20) connected to the fittings on the bottom of the pump and insert the quick connect plug (Item 21) on the top of the tank into the socket by lifting the tank up, then release the socket. The socket and plug should snap into place. (See Photos 21, 22 & 23)



Photo 21 – Quick Connect Tank Connection

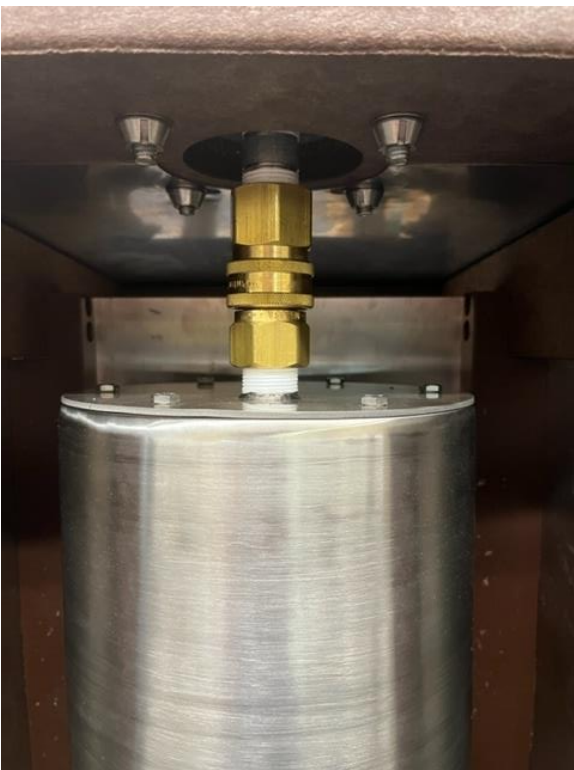

Photo 22 – Pump Fasteners and Tank Connection



Photo 23 – Tank Orientation

- 3) Once in place, turn the tank support bolts to raise them until flush with the bottom of the tank and hand tighten. **DO NOT OVERTIGHTEN**



Photo 24 – Tank Support Plate and Bolts

Step 5 - Attaching the Tank Lines:

- 1) Attach the water supply line (S) to the inlet ball valve (K-1) at the bottom left of the tank using a flex line (X). (See Details B & D and Photo 25)
- 2) The drain ball valve (K-2) at the bottom right of the tank is for attaching a drain line and should be closed or capped off when not draining. (See Detail D and Photo 22)
- 3) Make sure the inlet ball valve (K-1) is in the open position (handle is parallel to the line) if not already.
- 4) Make sure the drain connection is in the closed position (handle is perpendicular to the line) or capped off if not already.



Photo 25 – Tank Line Connections

Step 6 - Filling the Tank:

- 1) Turn on the city water supply line by opening the Shut off valve (R).
- 2) Open the inlet ball valve (K-1) if not already opened to allow the water to fill the tank
Note: The tank will be filled to approximately 2 gallons as a reserve for pumping.
- 3) Check for leaks at all inlet and tank connections and tighten if needed.
- 4) Reattach the access panel (E) with the four (4) provided fasteners (**Items 17 & 18**) using a 5/16" allen wrench.

Step 7 - Operation of Lil Guppy Playground Pump (A):

- 1) Begin pumping the handle on the Lil Guppy Playground Pump (A). Water should begin to flow from the spout after a few strokes.

Maintenance:

Pump - Periodic maintenance is required every 2-3 months. Cadron Creek Play suggests cleaning of the piston assembly with fresh clean water. Be sure to inspect the wear items like cup seals and O-rings. These can be replaced as needed using the Cadron Creek Play Maintenance Kit.

Note: Please refer to the Lil Guppy Playground Pump Owner's Manual for operation and maintenance information about the Lil Guppy Playground Pump.

Table - Wipe down with damp cloth as needed. Periodic cleaning will depend on the environment in which it is installed. Inspect for loose hardware and tighten as needed.

Winterizing the System:

***** Failure to winterize may void the warranty. *****

- 1) Shut off the water supply at the Shut off valve (R).
- 2) Remove the access panel.
- 3) Open or take off the cap on the drain ball valve (K-2) to drain the tank's water.
- 4) Close the inlet ball valve (K-1).
- 5) Disconnect and remove the pump from the pump platform (V).
- 6) Turn the pump with the spout facing down and pump until all water is removed.
- 7) Reconnect the pump to the pump platform and tank.
- 8) Once the tank is completely drained, close or re-cap the drain ball valve (K-2).

Note: To dewinterize, open the inlet ball valve (K-1) and restore flow from the water supply line (S) by opening the Shut off valve (R).

Appendix

Detail A: Waterfall Table System Components

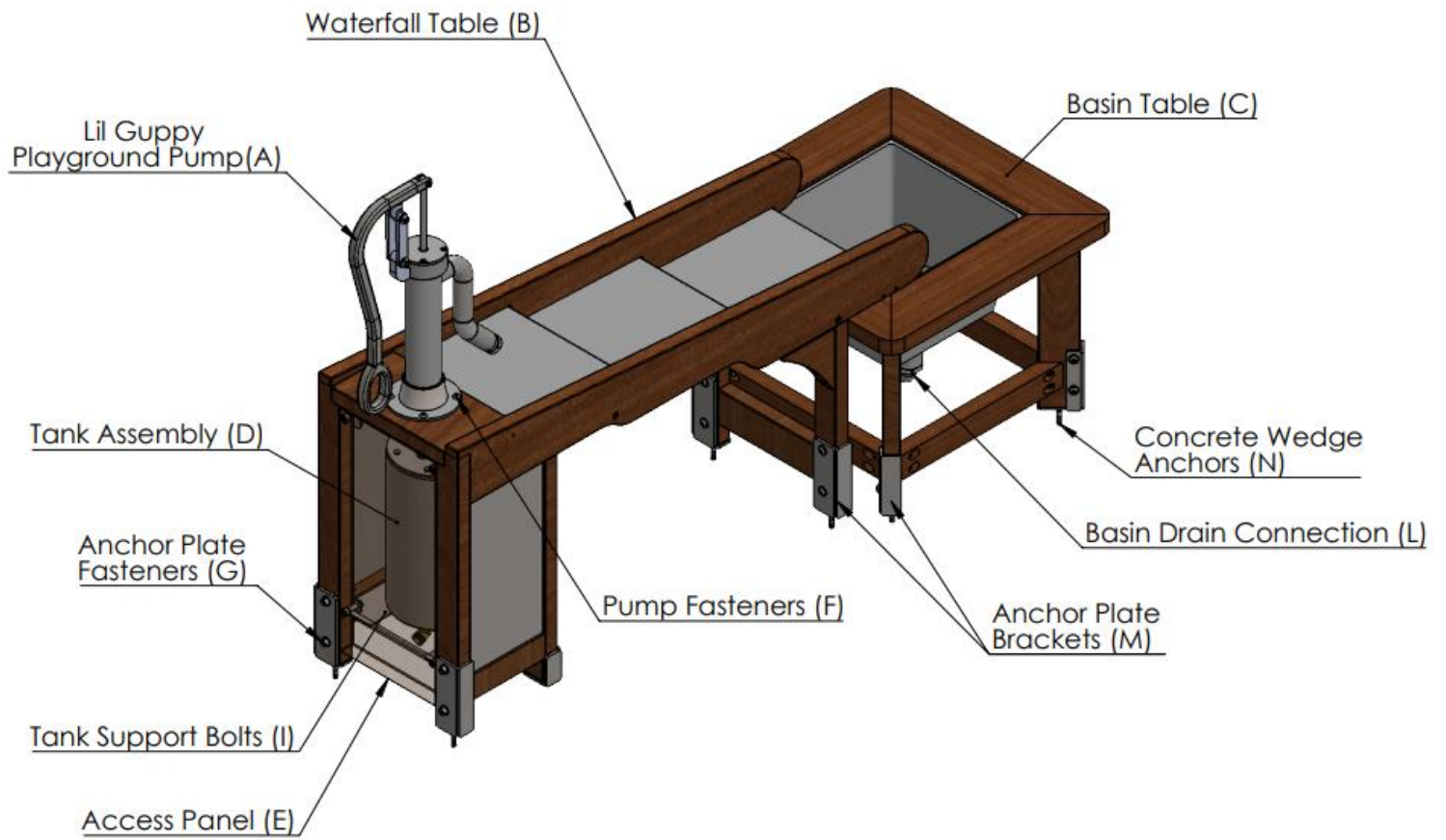

Detail B: Waterfall Table System Piping

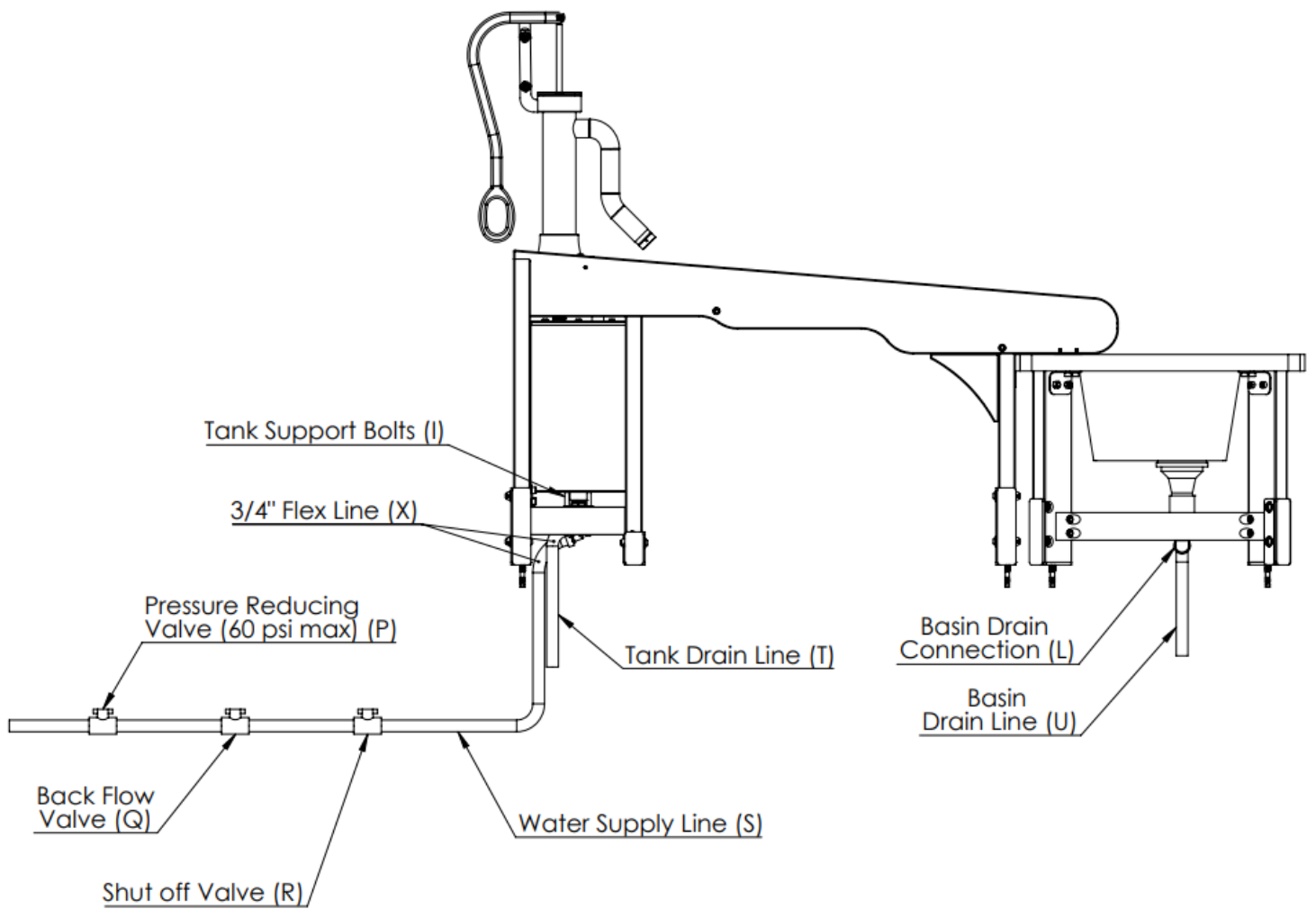

Detail C: Waterfall Table System Dimensions

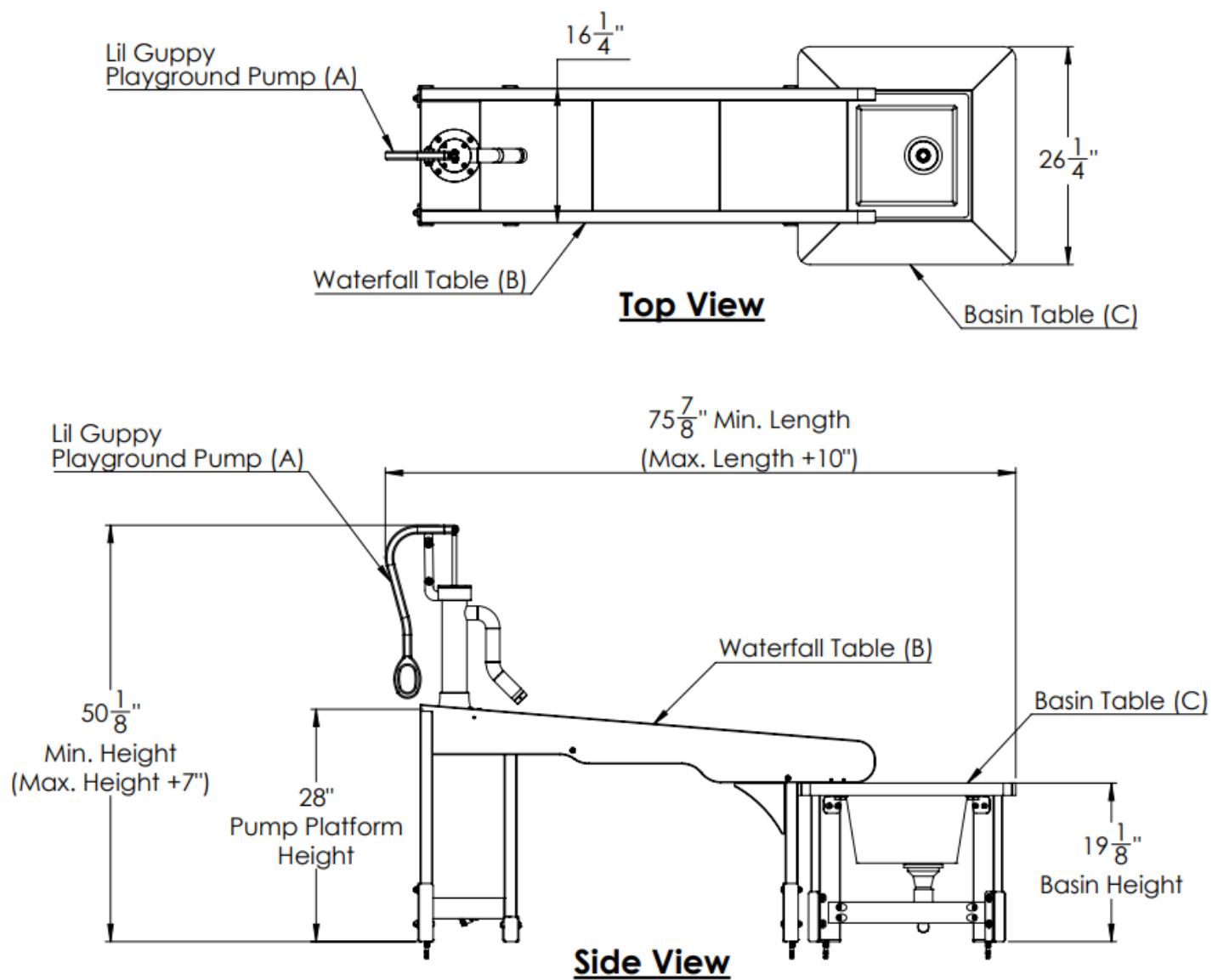

Detail D: Waterfall Table Pump & Tank

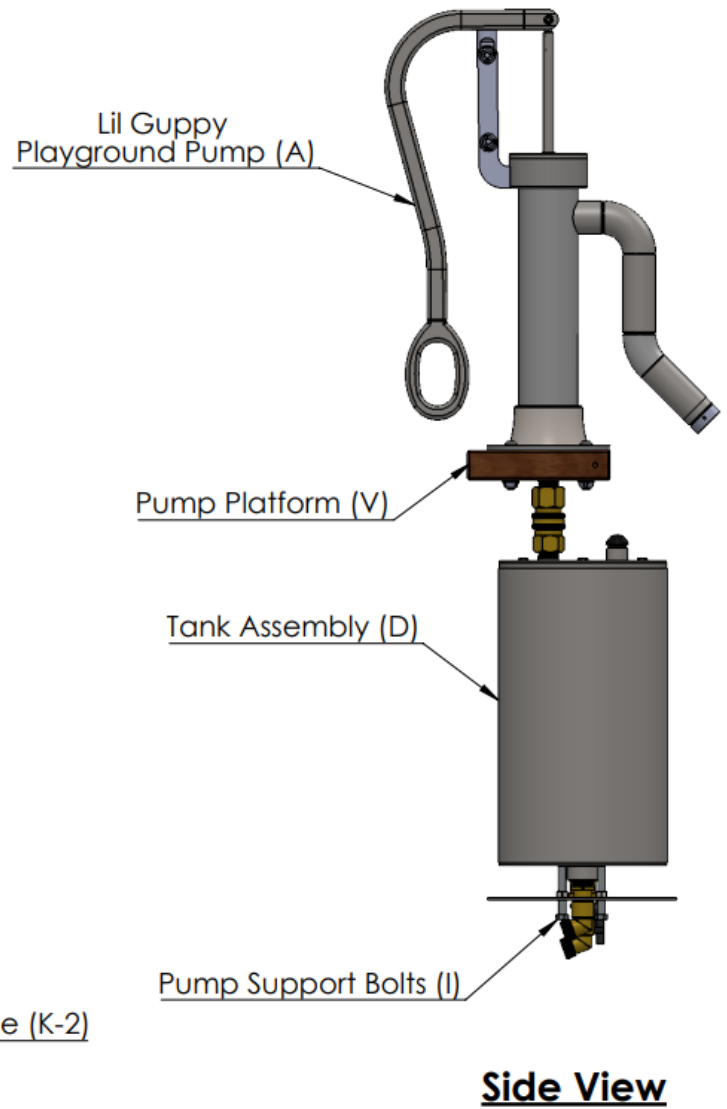
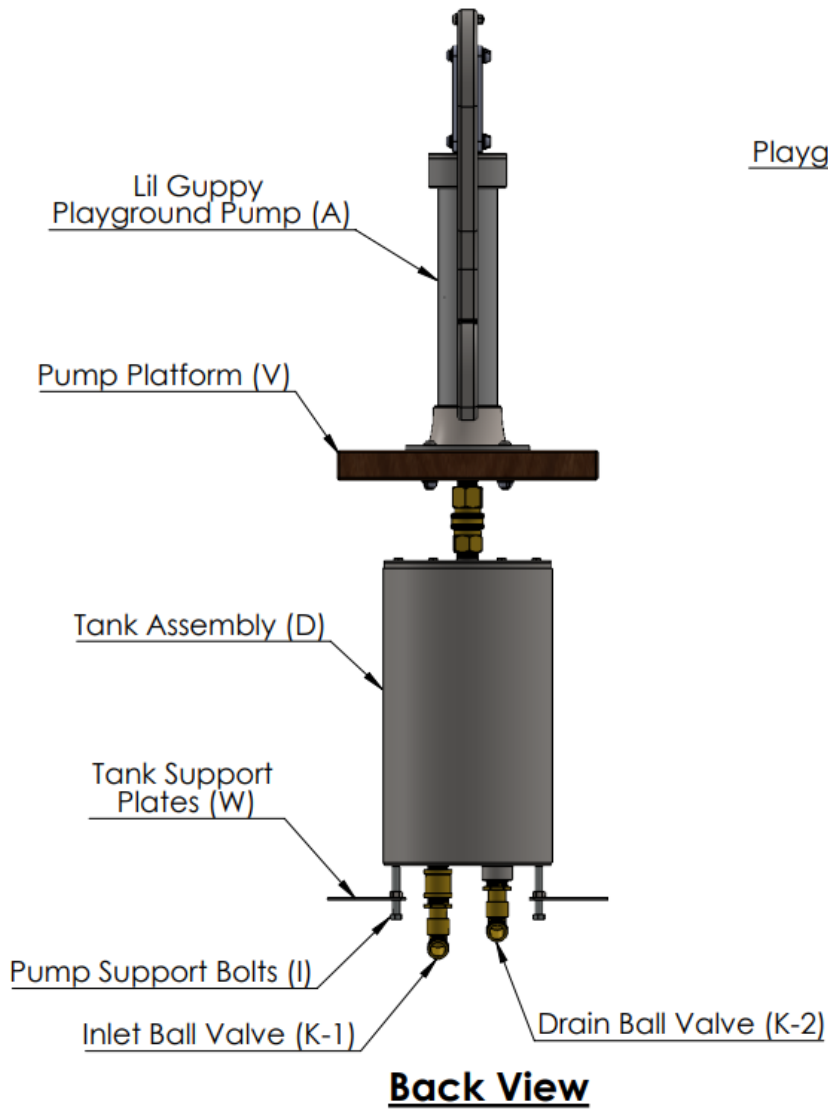

Detail E: Concrete Installation Layout

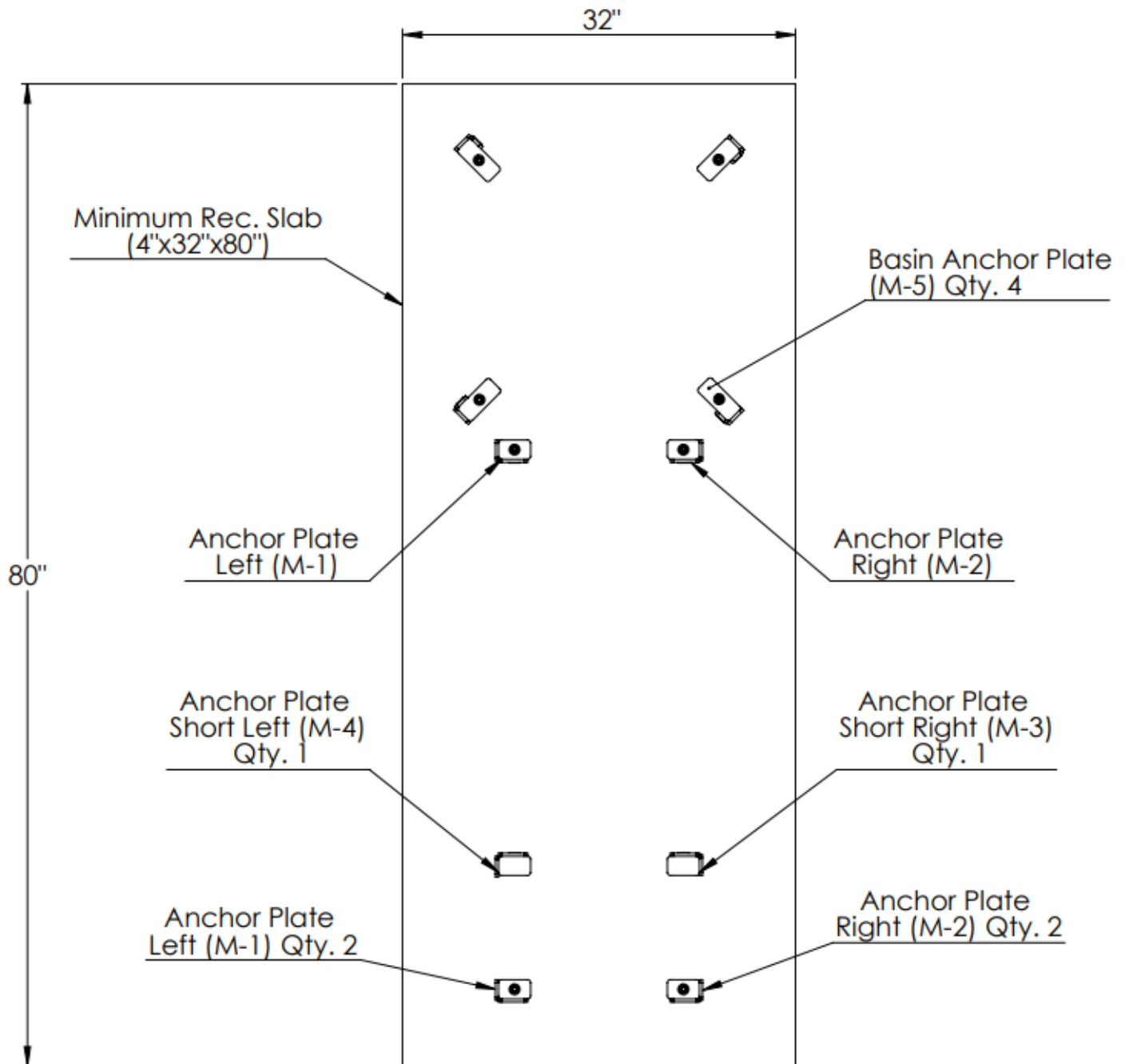

Detail F: Exploded Parts Diagram

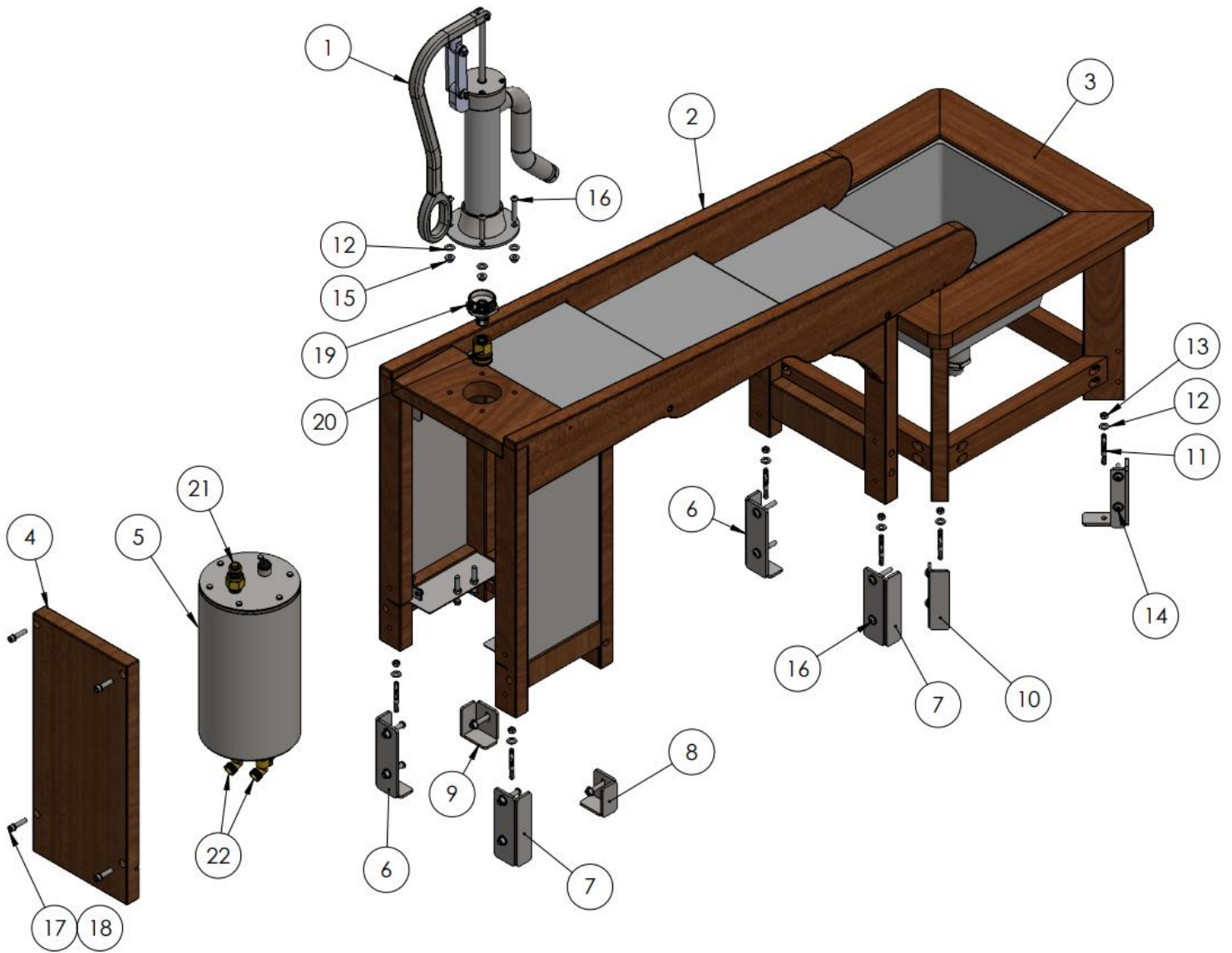

Detail G: Part Listing

Item No.	Part Number	Description	Quantity
1	60-001-0-00-01	Lil Guppy Playground Pump for WFT	1
2	66-001-0-01-01	Waterfall Table Assembly	1
3	66-002-0-01-01	Basin Table Assembly	1
4	66-001-0-01-08	Access Panel	1
5	66-001-0-14-01	Tank Assembly	1
6	66-001-0-15-01	Anchor Plate Assembly LH	2
7	66-001-0-16-01	Anchor Plate Assembly RH	2
8	66-001-0-17-01	Anchor Plate Assembly Short RH	1
9	66-001-0-18-01	Anchor Plate Assembly Short LH	1
10	66-002-0-11-01	Basin Table Anchor Plate Assembly	4
11	04-000-1-45-36	3/8"-16 Wedge Anchor	8
12	04-000-1-40-14	3/8" Flat Washer	30
13	04-000-1-50-22	3/8"-16 Hex Nut	8
14	04-000-1-46-11	3/8"-16 x 1.75" Button Head Bolt	8
15	04-000-1-55-02	3/8"-16 Security Nut	22
16	04-000-1-46-12	3/8"-16 x 2.25" Button Head Bolt	14
17	04-000-1-52-79	3/8"-16 x 1.5" Socket Head Bolt	4
18	04-000-1-40-16	Access Panel Flat Washer	4
19	04-029-2-74-06	Reducer Bushing	1
20	04-029-0-76-09	Quick Connect Socket	1
21	04-029-0-76-15	Quick Connect Plug	1
22	04-035-0-75-03	Tank Ball Valve	2